

## WINTER STREET NE

### CONSTRUCTION NOTES:

1. SAWCUT AND REMOVE EXISTING CONCRETE SIDEWALK TO LIMITS SHOWN. ALL SAWCUTS SHALL BE ON EXISTING SCORE JOINTS.
2. CONSTRUCT NEW CONCRETE SIDEWALK AS SHOWN AND PER SIDEWALK SECTION DETAIL ON SHEET DET-1.
3. MATCH EXISTING SIDEWALK AND/OR CURB GRADE. SLOPE TRANSITIONS MAY BE NECESSARY TO MATCH INTO EXISTING.
4. REMOVE AND RELOCATE EXISTING BUS STOP SIGN. SALVAGE ALL ABOVE GROUND MATERIALS.
5. REINSTALL EXISTING BUS STOP SIGN PER DETAILS ON SHEET DET-1. COORDINATE WITH SAMTD TO OBTAIN SIGN MATERIALS.
6. INSTALL CURB PER DETAIL ON SHEET DET-1.
7. INSTALL NEW NO PARKING SIGN PER DETAILS ON SHEET DET-1. COORDINATE FINAL SIGN LOCATION CITY TRAFFIC ENGINEER.

### GENERAL NOTES:

1. ALL CONSTRUCTION TO BE IN ACCORDANCE WITH PERMITTING AGENCY STANDARD CONSTRUCTION SPECIFICATIONS AND STANDARD PLAN SIDEWALK DETAILS.
2. CONTRACTOR TO OBTAIN ALL REQUIRED CONSTRUCTION PERMITS.
3. IRRIGATION SYSTEM MAY BE PRESENT. CONTRACTOR TO NOTIFY PROJECT MANAGER IF IRRIGATION SYSTEM WILL BE IMPACTED BY PROPOSED IMPROVEMENTS.
4. EXISTING LANDSCAPING AND/OR GRASS SHALL BE RESTORED IN ALL AREAS IMPACTED FROM CONSTRUCTION ACTIVITIES.
5. PROTECT ALL EXISTING UTILITIES IN PLACE UNLESS OTHERWISE NOTED. CONTRACTOR SHALL VERIFY ALL UTILITY LOCATIONS PRIOR TO CONSTRUCTION.
6. PROTECT NEAREST DOWNSTREAM CATCH BASIN WITH SILT SACK WITH STANDARD PLAN #913 AND/OR #914. REMOVE PROTECTION WHEN WORK IS COMPLETE.
7. CONTRACTOR SHALL IMMEDIATELY REMOVE AND CLEAN UP ANY SOIL DEPOSITED ON EXISTING SIDEWALKS AND STREETS.
8. PROTECT EXISTING CURB FROM DAMAGE. ANY DAMAGED CURB SHALL BE REPLACED AT CONTRACTOR'S EXPENSE.
9. CONTRACTOR SHALL RECEIVE APPROVAL FROM CITY TRAFFIC ENGINEER PRIOR TO ANY REMOVAL, RELOCATION, OR INSTALLATION OF CITY SIGNAGE.

### LEGEND

EXISTING CURB	
EXISTING CONCRETE	
EXISTING LANDSCAPING	
EXISTING UTILITY POLE	
EXISTING SIGN	
EXISTING TREE	
EXISTING STORM LINE	
PROPOSED SIGN	
PROPOSED NO PARKING SIGN	
PROPOSED SIDEWALK	
PROPOSED CURB	

DATE 6/29/18	REVISION C C C C C	BY AVF	DRAFTER JMW	DESIGNER RDV	CHECKER MSM	REVIEWER	ACCOMPANIED BY DWGS.	REGISTERED PROFESSIONAL ENGINEER OREGON JAN 8, 2008 RAWLEY D. VOORHIES EXPIRES: 6-30-18	CENTURY WEST ENGINEERING 5531 SW MACADAM AVE., #287 503.419.2130 PORTLAND, OR 97239 503.639.2710 FAX	Cherriots SALEM-KEIZER TRANSIT PROJECT MANAGER: STEVE DICKEY (503) 588-2424	BUS STOP NO. 117025 DATE AUGUST 1, 2018 TRAPEZE NO.	WINTER STREET NE @ D STREET NE SE CORNER (OUTBOUND) BUS STOP IMPROVEMENT PROJECT LAYOUT DRAWING	SHEET NO. 9 OF 15 DRAWING NO. C-32
-----------------	-----------------------	-----------	----------------	-----------------	----------------	----------	----------------------	---	---	--	---	--	---

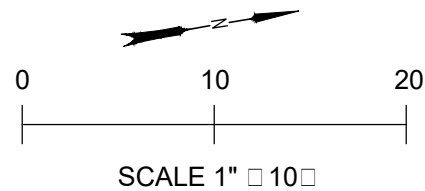

BELMONT STREET NE

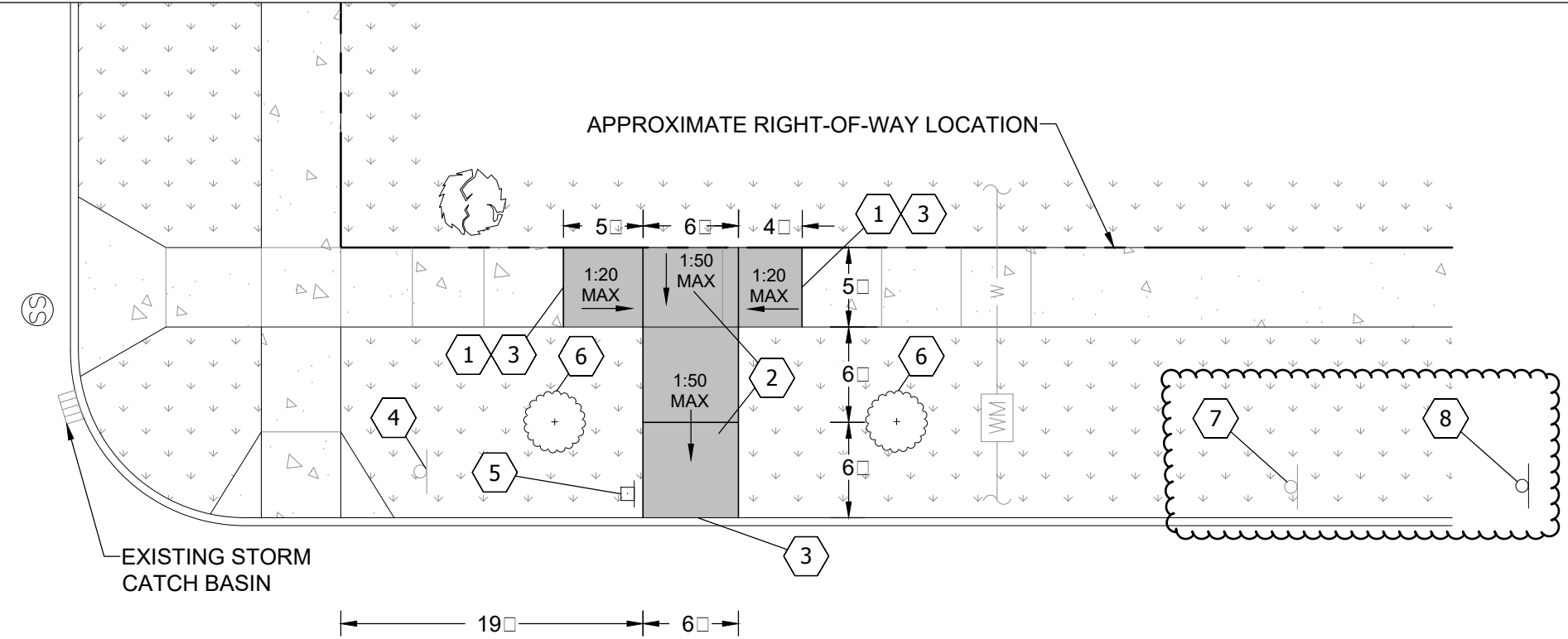

WINTER STREET NE

PROPOSED 90' NO PARKING LIMITS

GENERAL NOTES:

1. ALL CONSTRUCTION TO BE IN ACCORDANCE WITH PERMITTING AGENCY STANDARD CONSTRUCTION SPECIFICATIONS AND STANDARD PLAN SIDEWALK DETAILS.
2. CONTRACTOR TO OBTAIN ALL REQUIRED CONSTRUCTION PERMITS.
3. IRRIGATION SYSTEM MAY BE PRESENT. CONTRACTOR TO NOTIFY PROJECT MANAGER IF IRRIGATION SYSTEM WILL BE IMPACTED BY PROPOSED IMPROVEMENTS.
4. EXISTING LANDSCAPING AND/OR GRASS SHALL BE RESTORED IN ALL AREAS IMPACTED FROM CONSTRUCTION ACTIVITIES.
5. PROTECT ALL EXISTING UTILITIES IN PLACE UNLESS OTHERWISE NOTED. CONTRACTOR SHALL VERIFY ALL UTILITY LOCATIONS PRIOR TO CONSTRUCTION.
6. PROTECT NEAREST DOWNSTREAM CATCH BASIN WITH SILT SACK WITH STANDARD PLAN #913 AND/OR #914. REMOVE PROTECTION WHEN WORK IS COMPLETE.
7. CONTRACTOR SHALL IMMEDIATELY REMOVE AND CLEAN UP ANY SOIL DEPOSITED ON EXISTING SIDEWALKS AND STREETS.
8. PROTECT EXISTING CURB FROM DAMAGE. ANY DAMAGED CURB SHALL BE REPLACED AT CONTRACTOR'S EXPENSE.
9. CONTRACTOR SHALL RECEIVE APPROVAL FROM CITY TRAFFIC ENGINEER PRIOR TO ANY REMOVAL, RELOCATION, OR INSTALLATION OF CITY SIGNAGE.

LEGEND

- EXISTING CURB
- EXISTING CONCRETE
- EXISTING LANDSCAPING
- EXISTING SIGN
- EXISTING TREE
- EXISTING WATER LINE
- EXISTING WATER METER
- EXISTING SHRUB
- EXISTING SANITARY SEWER MANHOLE
- PROPOSED SIGN
- PROPOSED NO PARKING SIGN
- PROPOSED SIDEWALK

CONSTRUCTION NOTES:

- 1 SAWCUT AND REMOVE EXISTING CONCRETE SIDEWALK TO LIMITS SHOWN. ALL SAWCUTS SHALL BE ON EXISTING SCORE JOINTS.
- 2 CONSTRUCT NEW CONCRETE SIDEWALK AS SHOWN AND PER SIDEWALK SECTION DETAIL ON SHEET DET-1.
- 3 MATCH EXISTING SIDEWALK AND/OR CURB GRADE. SLOPE TRANSITIONS MAY BE NECESSARY TO MATCH INTO EXISTING.
- 4 REMOVE AND RELOCATE EXISTING BUS STOP SIGN. SALVAGE ALL ABOVE GROUND MATERIALS.
- 5 REINSTALL EXISTING BUS STOP SIGN PER DETAILS ON SHEET DET-1. COORDINATE WITH SAMTD TO OBTAIN SIGN MATERIALS.
- 6 EXISTING TREES SHALL BE PROTECTED IN ALL AREAS IMPACTED FROM CONSTRUCTION ACTIVITIES.
- 7 EXISTING PARKING SIGN TO BE RELOCATED TO LOCATION APPROVED BY CITY TRAFFIC ENGINEER.
- 8 INSTALL NEW NO PARKING SIGN PER DETAIL #1 ON SHEET DET-02. COORDINATE FINAL SIGN LOCATION CITY TRAFFIC ENGINEER.

	DATE	REVISION	BY	DRAFTER: AVF				BUS STOP NO. 117350	WINTER STREET NE @ BELMONT STREET NE NW CORNER (INBOUND) BUS STOP IMPROVEMENT PROJECT	SHEET NO. 10 OF 15
	6/29/18	C <input type="checkbox"/> <input type="checkbox"/> <input type="checkbox"/> <input type="checkbox"/> <input type="checkbox"/>						DESIGNER: JMW		DATE AUGUST 1, 2018
				RDV						
ACCOMPANIED BY DWGS. _____				CHECKER: MSM			PROJECT MANAGER: STEVE DICKEY (503) 588-2424	TRAPEZE NO.	LAYOUT DRAWING	DRAWING NO. C-33
				REVIEWER: _____	OREGON JAN 8, 2008 PAWLEY D. VOORHES EXPIRES: 6-30-16	531 SW MACADAM AVE., #287 503.419.2130 PORTLAND, OR 97239 503.639.2710 FAX				

ATTACHMENT 2

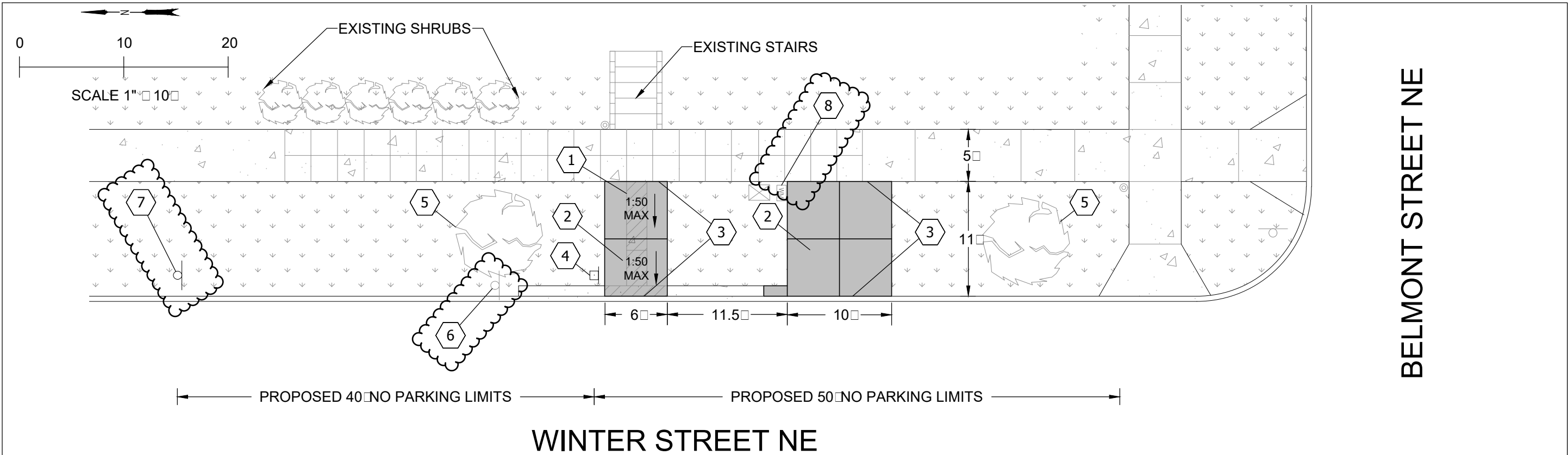

BELMONT STREET NE

## WINTER STREET NE

### CONSTRUCTION NOTES:

1. SAWCUT AND REMOVE EXISTING CONCRETE SIDEWALK TO LIMITS SHOWN. ALL SAWCUTS SHALL BE ON EXISTING SCORE JOINTS.
2. CONSTRUCT NEW CONCRETE SIDEWALK AS SHOWN AND PER SIDEWALK SECTION DETAIL ON SHEET DET-1.
3. MATCH EXISTING SIDEWALK AND/OR CURB GRADE. SLOPE TRANSITIONS MAY BE NECESSARY TO MATCH INTO EXISTING.
4. INSTALL NEW BUS STOP SIGN PER DETAIL ON SHEET DET-1. COORDINATE WITH SAMTD TO OBTAIN SIGN MATERIALS.
5. EXISTING TREES SHALL BE PROTECTED IN ALL AREAS IMPACTED FROM CONSTRUCTION ACTIVITIES.
6. RELOCATE EXISTING NO PARKING SIGN TO LOCATION APPROVED BY CITY TRAFFIC ENGINEER.
7. INSTALL NEW NO PARKING SIGN PER DETAIL #4 ON SHEET DET-02. COORDINATE FINAL SIGN LOCATION CITY TRAFFIC ENGINEER.
8. ADJUST ELEVATION OF EXISTING WATER METER TO MATCH ADJACENT PROPOSED SIDEWALK ELEVATION.

### GENERAL NOTES:

1. ALL CONSTRUCTION TO BE IN ACCORDANCE WITH PERMITTING AGENCY STANDARD CONSTRUCTION SPECIFICATIONS AND STANDARD PLAN SIDEWALK DETAILS.
2. CONTRACTOR TO OBTAIN ALL REQUIRED CONSTRUCTION PERMITS.
3. IRRIGATION SYSTEM MAY BE PRESENT. CONTRACTOR TO NOTIFY PROJECT MANAGER IF IRRIGATION SYSTEM WILL BE IMPACTED BY PROPOSED IMPROVEMENTS.
4. EXISTING LANDSCAPING AND/OR GRASS SHALL BE RESTORED IN ALL AREAS IMPACTED FROM CONSTRUCTION ACTIVITIES.
5. PROTECT ALL EXISTING UTILITIES IN PLACE UNLESS OTHERWISE NOTED. CONTRACTOR SHALL VERIFY ALL UTILITY LOCATIONS PRIOR TO CONSTRUCTION.
6. PROTECT NEAREST DOWNSTREAM CATCH BASIN WITH SILT SACK WITH STANDARD PLAN #913 AND/OR #914. REMOVE PROTECTION WHEN WORK IS COMPLETE.
7. CONTRACTOR SHALL IMMEDIATELY REMOVE AND CLEAN UP ANY SOIL DEPOSITED ON EXISTING SIDEWALKS AND STREETS.
8. PROTECT EXISTING CURB FROM DAMAGE. ANY DAMAGED CURB SHALL BE REPLACED AT CONTRACTOR'S EXPENSE.
9. CONTRACTOR SHALL RECEIVE APPROVAL FROM CITY TRAFFIC ENGINEER PRIOR TO ANY REMOVAL, RELOCATION, OR INSTALLATION OF CITY SIGNAGE.

### LEGEND

- |                                 |  |
|---------------------------------|--|
| EXISTING CURB                   |  |
| EXISTING CONCRETE               |  |
| EXISTING LANDSCAPING            |  |
| EXISTING SIGN                   |  |
| EXISTING TREE                   |  |
| EXISTING WATER METER            |  |
| EXISTING IRRIGATION             |  |
| PROPOSED SIDEWALK               |  |
| EXISTING SIDEWALK TO BE REMOVED |  |
| PROPOSED SIGN                   |  |
| PROPOSED NO PARKING SIGN        |  |

DATE	REVISION	BY	DRAFTER: AVF	DESIGNER: JMW	CHECKER: RDV	REVIEWER: MSM	CENTURY WEST ENGINEERING 5531 SW MACADAM AVE., #287 503.419.2130 PORTLAND, OR 97239 503.639.2710 FAX	Cherriots SALEM-KEIZER TRANSIT PROJECT MANAGER: STEVE DICKEY (503) 588-2424	BUS STOP NO. 117032B DATE AUGUST 1, 2018 TRAPEZE NO.	WINTER ST NE @ BELMONT ST NE NE CORNER (OUTBOUND) BUS STOP IMPROVEMENT PROJECT LAYOUT DRAWING	SHEET NO. 12 OF 15 DRAWING NO. C-34
6/29/18	C-34										

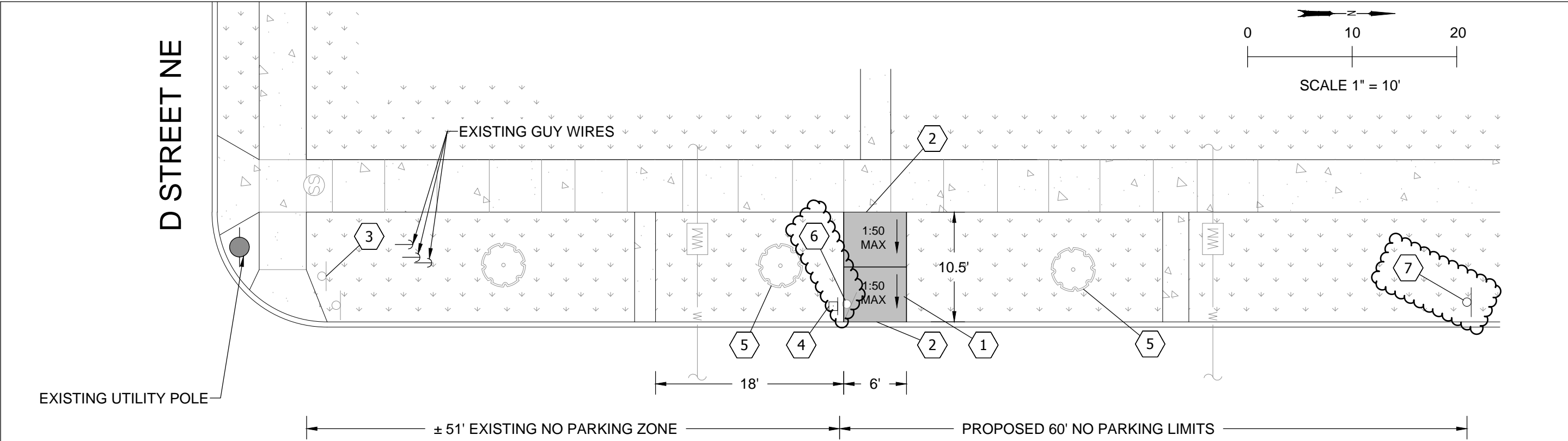

WINTER STREET NE

CONSTRUCTION NOTES:

- 1. CONSTRUCT NEW CONCRETE SIDEWALK AS SHOWN AND PER SIDEWALK SECTION DETAIL ON SHEET DET-1.
- 2. MATCH EXISTING SIDEWALK AND/OR CURB GRADE. SLOPE TRANSITIONS MAY BE NECESSARY TO MATCH INTO EXISTING.
- 3. REMOVE AND RELOCATE EXISTING BUS STOP SIGN. SALVAGE ALL ABOVE GROUND MATERIALS.
- 4. REINSTALL EXISTING BUS STOP SIGN PER DETAIL ON SHEET DET-1. COORDINATE WITH SAMTD TO OBTAIN SIGN MATERIALS.
- 5. EXISTING TREES SHALL BE PROTECTED IN ALL AREAS IMPACTED FROM CONSTRUCTION ACTIVITIES.
- 6. RELOCATE EXISTING NO PARKING SIGN TO LOCATION APPROVED BY CITY TRAFFIC ENGINEER.
- 7. INSTALL NEW NO PARKING SIGN PER DETAILS ON SHEET DET-2. COORDINATE FINAL SIGN LOCATION WITH CITY TRAFFIC ENGINEER.

GENERAL NOTES:

- 1. ALL CONSTRUCTION TO BE IN ACCORDANCE WITH PERMITTING AGENCY STANDARD CONSTRUCTION SPECIFICATIONS AND STANDARD PLAN SIDEWALK DETAILS.
- 2. CONTRACTOR TO OBTAIN ALL REQUIRED CONSTRUCTION PERMITS.
- 3. IRRIGATION SYSTEM MAY BE PRESENT. CONTRACTOR TO NOTIFY PROJECT MANAGER IF IRRIGATION SYSTEM WILL BE IMPACTED BY PROPOSED IMPROVEMENTS.
- 4. EXISTING LANDSCAPING AND/OR GRASS SHALL BE RESTORED IN ALL AREAS IMPACTED FROM CONSTRUCTION ACTIVITIES.
- 5. PROTECT ALL EXISTING UTILITIES IN PLACE UNLESS OTHERWISE NOTED. CONTRACTOR SHALL VERIFY ALL UTILITY LOCATIONS PRIOR TO CONSTRUCTION.
- 6. PROTECT NEAREST DOWNSTREAM CATCH BASIN WITH SILT SACK WITH STANDARD PLAN #913 AND/OR #914. REMOVE PROTECTION WHEN WORK IS COMPLETE.
- 7. CONTRACTOR SHALL IMMEDIATELY REMOVE AND CLEAN UP ANY SOIL DEPOSITED ON EXISTING SIDEWALKS AND STREETS.
- 8. PROTECT EXISTING CURB FROM DAMAGE. ANY DAMAGED CURB SHALL BE REPLACED AT CONTRACTOR'S EXPENSE.
- 9. CONTRACTOR SHALL RECEIVE APPROVAL FROM CITY TRAFFIC ENGINEER PRIOR TO ANY REMOVAL, RELOCATION, OR INSTALLATION OF CITY SIGNAGE.

LEGEND

- EXISTING CURB
- EXISTING CONCRETE
- EXISTING LANDSCAPING
- EXISTING UTILITY POLE
- EXISTING SIGN
- EXISTING TREE
- EXISTING STORM LINE
- PROPOSED SIGN
- PROPOSED NO PARKING SIGN

DATE	6/29/18	REVISION	BY	DRAFTER: AVF	DESIGNER: JMW	CHECKER: RDV	REVIEWER: MSM	CENTURY WEST ENGINEERING 5531 SW MACADAM AVE., #287 503.419.2130 PORTLAND, OR 97239 503.639.2710 FAX	Cherriots SALEM-KEIZER TRANSIT PROJECT MANAGER: STEVE DICKEY (503) 588-2424	BUS STOP NO. 117355B DATE AUGUST 1, 2018 TRAPEZE NO.	WINTER STREET NE @ D STREET NE NW CORNER BUS STOP IMPROVEMENT PROJECT LAYOUT DRAWING	SHEET NO. 13 OF 15 DRAWING NO. C-35