

# ATTACHMENT 1: PROJECT LOCATION MAP

## WEST SALEM PUMP STATION ACCESS ROAD EMERGENCY REPAIR PROJECT

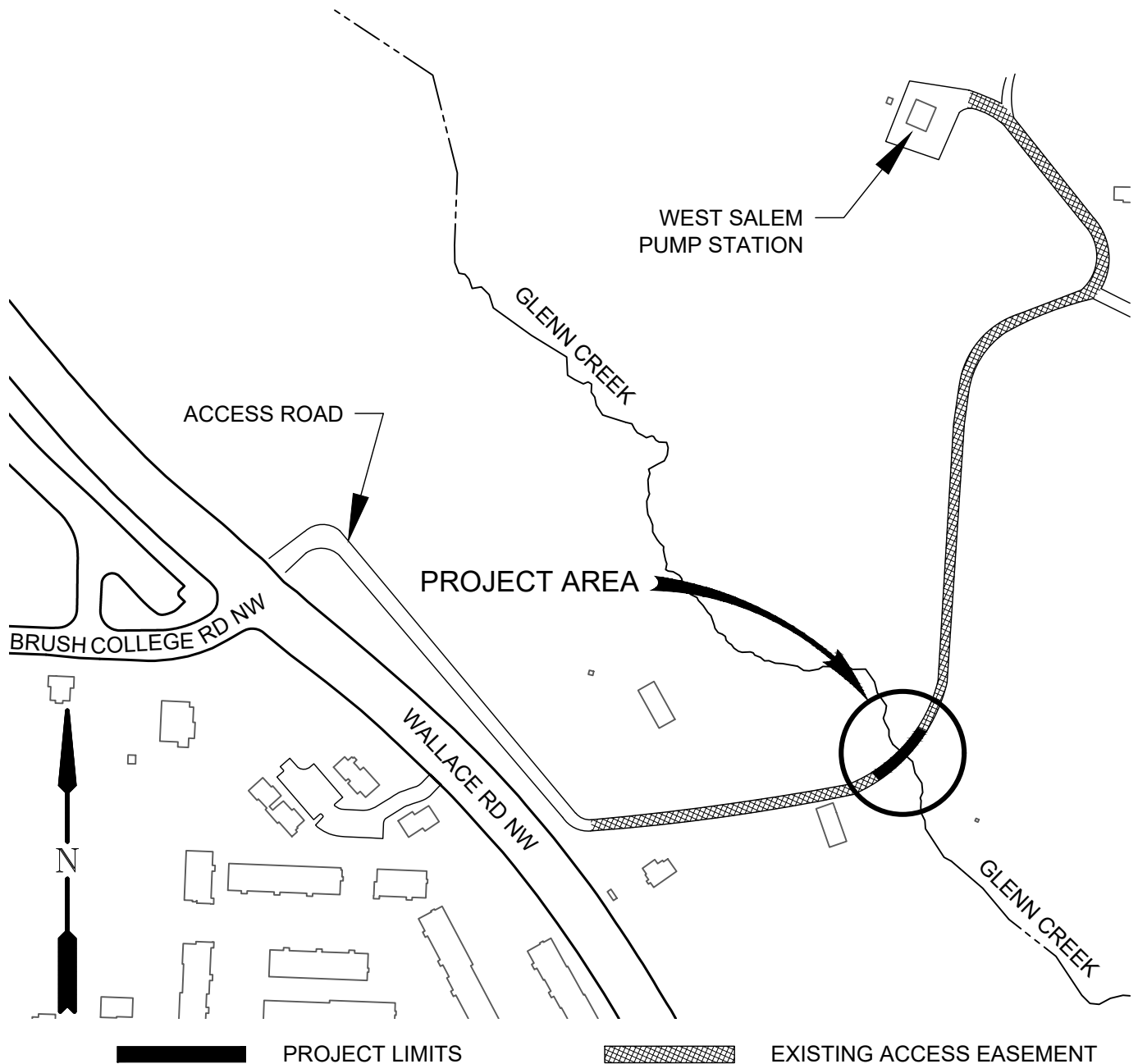

**Public Works Department**  
APWA ACCREDITED AGENCY

### ENGINEERING DIVISION

Physical Address:

1457 23rd St SE,

Salem, OR 97302

Phone 503-588-6211

[www.cityofsalem.net](http://www.cityofsalem.net)

Mailing Address:

PO Box 14300

Salem, OR 97309-1457