

IDENTIFIED PROPERTIES

CENTER STREET: LANCASTER DR TO 45TH PL NE PROJECT PN: 721515

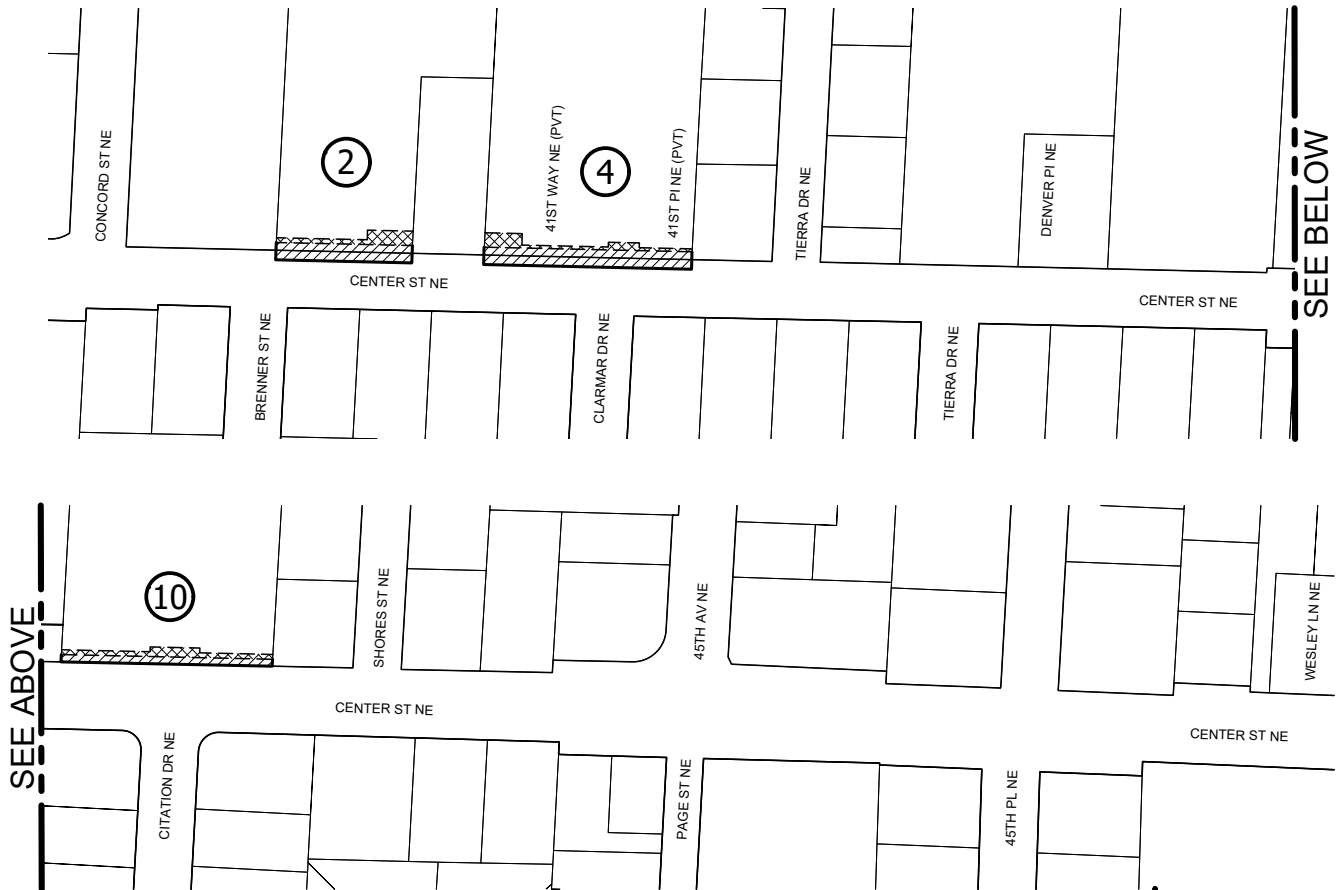

SEE ABOVE

SEE BELOW

LEGEND



PERMANENT RIGHT-OF-WAY EASEMENT
ACQUISITION AREA

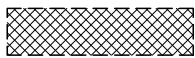

APPROXIMATE TEMPORARY CONSTRUCTION EASEMENT
(TCE) ACQUISITION AREA



PROPERTY ID NUMBER



Public Works Department

APWA ACCREDITED AGENCY

ENGINEERING DIVISION
555 Liberty Street SE, Room 325
Salem, OR 97301-3513
Phone 503-588-6211
www.cityofsalem.net

May 2023